

# Wireless Antenna for DVB-H EU band receivers Applications

Pulse Part Number CW3520



## Features

- High gain (MBRAI +4 dB)
- External antenna
- Ultra thin
- Compact size W x L x H (50.5 x 10.5 x 3.0 mm)
- MMCX connector
- Lead free materials
- Tray packing
- RoHS Compliant Product
- Color Black

## Applications

- DVB-H EU band receivers

## Electrical specifications @ +25 °C

Note: Electrical characteristics depend on test board (GP) size and antenna positioning on GP.

Test board size 100 x 45 mm

Frequency Range [MHz]	Max 3D Gain [dBi]	Return loss min. [dB]	Impedance [ $\Omega$ ]	Operating Temperature [ $^{\circ}$ C]
470-750	-4.5 @ 470 -3.5 @ 750	-3	50	-40 to +85

# Wireless Antenna for DVB-H EU band receivers Applications

Pulse Part Number CW3520

## Terminal Configuration

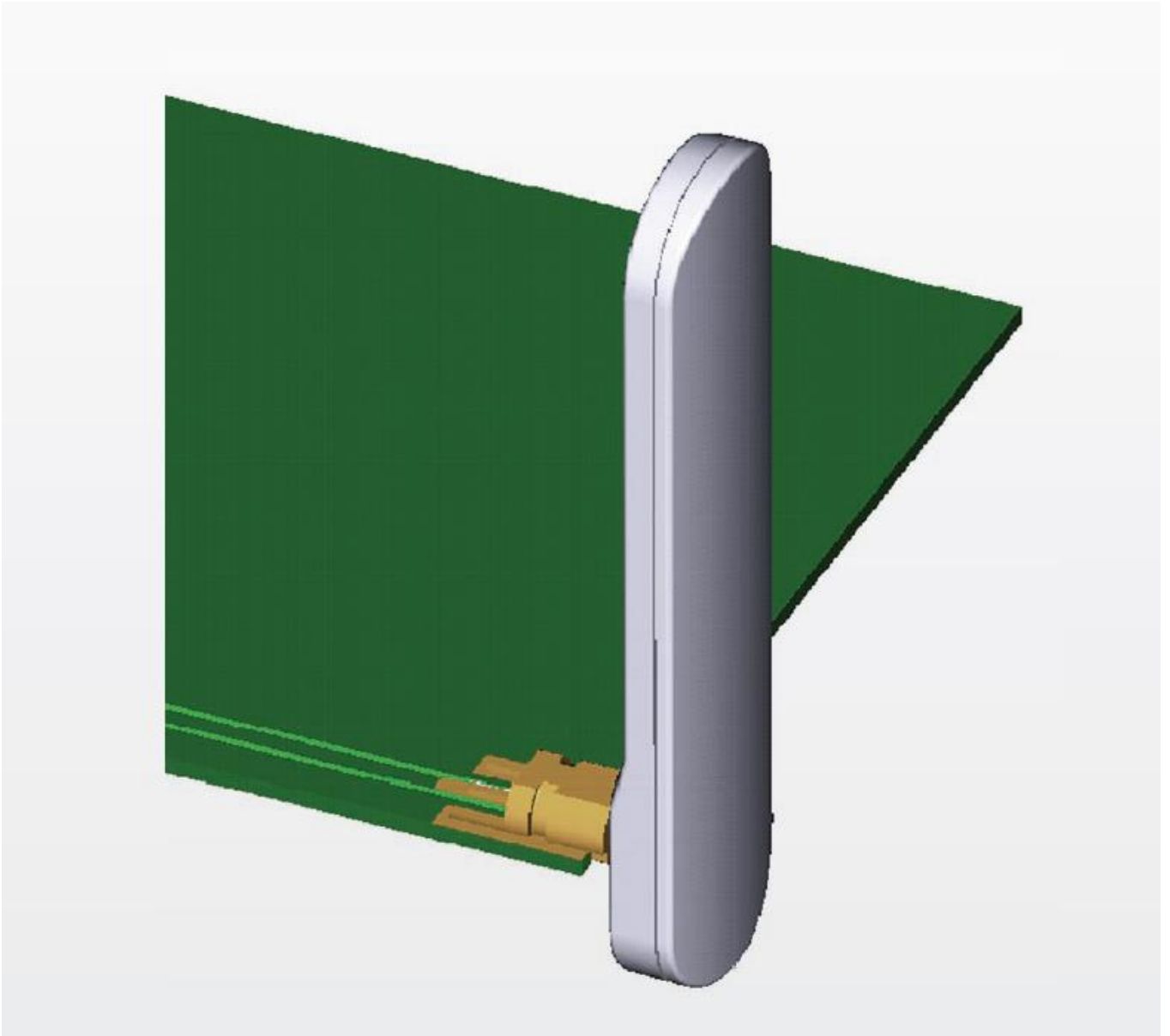

### Antenna Features

No.	Terminal name	Terminal Dimensions
1	Feed	MMCX Connector

# Wireless Antenna for DVB-H EU band receivers Applications

Pulse Part Number CW3520

## Typical Electrical Characteristics (T=25 °C)

Measured on the 100 x 45mm blank test board without external matching circuits, no other mechanics included.

### Typical Return Loss S11/ impedance

DVB-H Antenna

CH1Markers

- 1. -3.228 dB 470.000 MHz
- 2. -2.892 dB 750.000 MHz

CH1 S11 LOG

3 dB/REF 0 dB

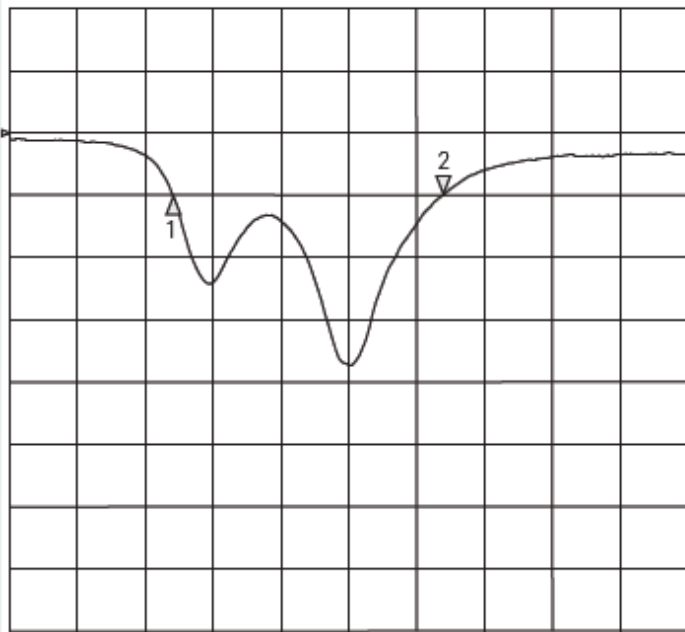

START 300.000 000 MHz

STOP 1 000.000 000 MHz

DVB-H Antenna

- 1. 49.254  $\Omega$  95.125 nH 470.000 MHz
- 2. 8.7915  $\Omega$  12.823 nH 750.000 MHz

CH1 S11 1 U FS

PRm  
Del  
Cor

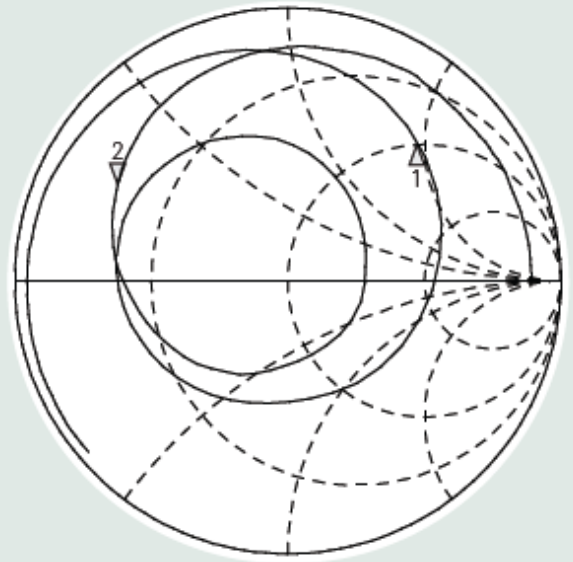

START 300.000 000 MHz

STOP 1 000.000 000 MHz

### Free space maximum gain

Max Gain [dB]

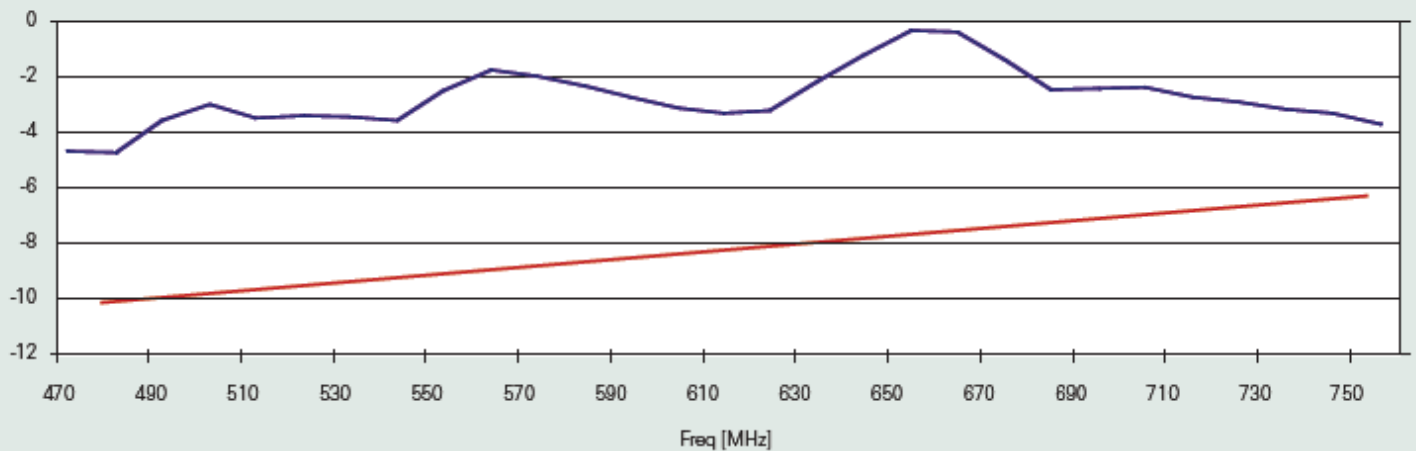

Standard DVB-H Antenna

Contact: [mobiledeviceantenna.sales@pulseelectronics.com](mailto:mobiledeviceantenna.sales@pulseelectronics.com)

# Wireless Antenna for DVB-H EU band receivers Applications

Pulse Part Number CW3520

## Typical Free space Radiation Patterns

