

1.575GHz GPS Ceramic Chip Antenna

Pulse Part Number CW3010

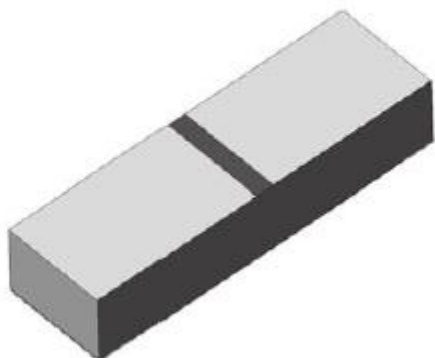

Features

- Omnidirectional radiation
- Low profile
- Compact size WxLxH (10 x 3.2 x 2 mm)
- Low weight (310 mg)
- Lead free materials
- Fully SMD compatible
- Lead free soldering compatible
- Tape and reel packing
- RoHS Compliant Product

Applications

- GPS L1 band
- 1.575 GHz

Electrical specifications @ +25 °C

Note: Electrical characteristics depend on test board (GP) size and antenna positioning on GP and Ground Clearance area size.

Typical performance (testboard size 80x37 mm, PWB ground clearance area 10.6 x 6.25 mm)

Frequency Range [MHz]	Linear Max Gain [dBi]	RHCP Gain [dBic]	Return loss min. [dB]	Efficiency [%]/[dB]	Impedance [Ω]	Operating Temperature [° C]
1575.42 +/- 10	2.8 (peak) 2.3 (band edges)	-0.2 (peak) -0.7 (band edges)	-18	75 / -1.25(peak) 70 / -1.55(band edges)	50	-40 to +85

1.575GHz GPS Ceramic Chip Antenna

Pulse Part Number CW3010

Typical Electrical Characteristics (T=25 °C)

Measured on the 80x37mm test board without matching circuit

Typical Return Loss S11/ impedance

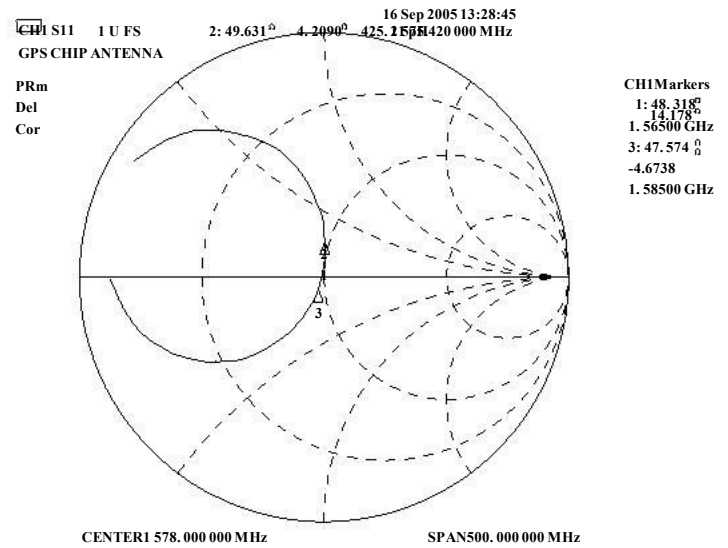
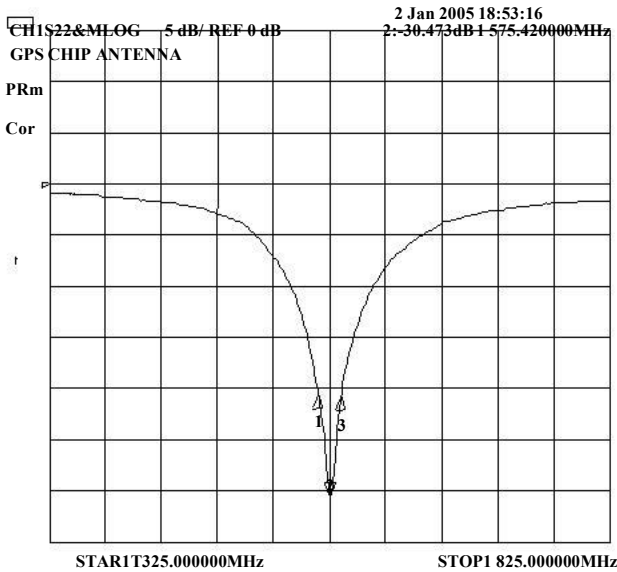

Free space efficiency and maximum gain

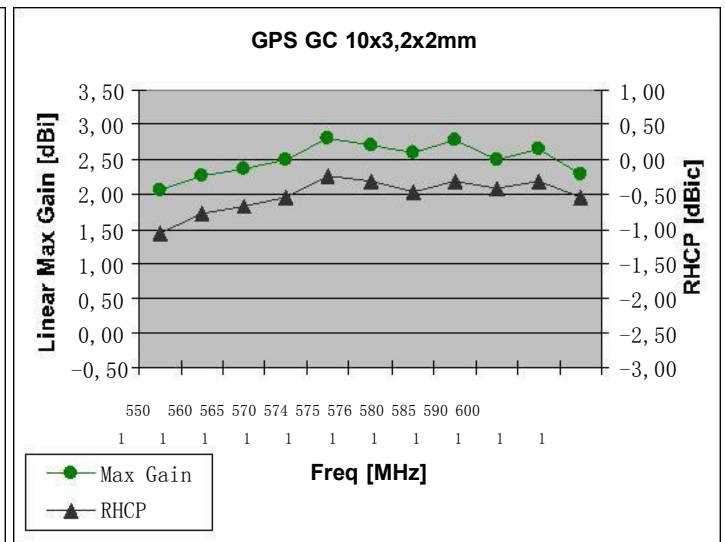
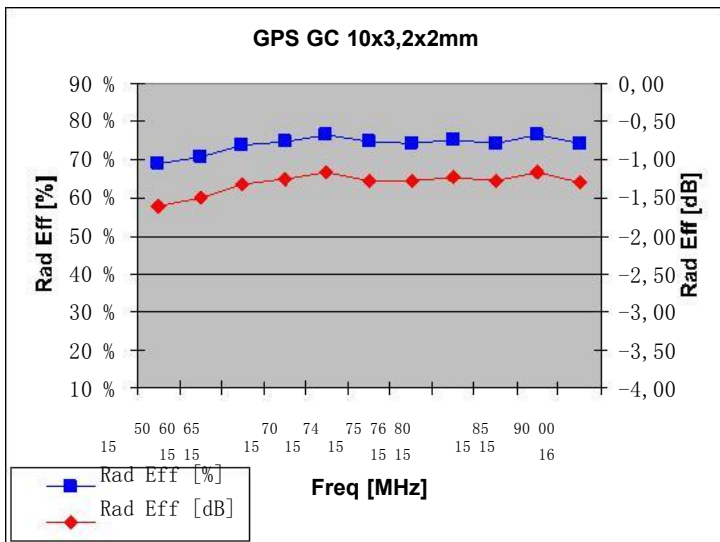

1.575GHz GPS Ceramic Chip Antenna

Pulse Part Number CW3010

Typical Free space Radiation Patterns

XZ-PLANE

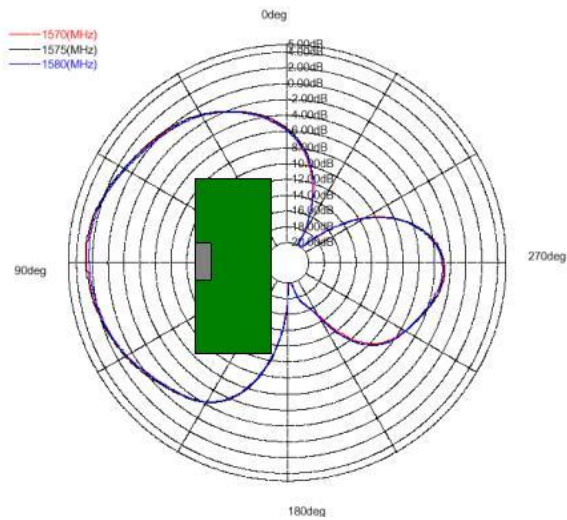

ZY-PLANE

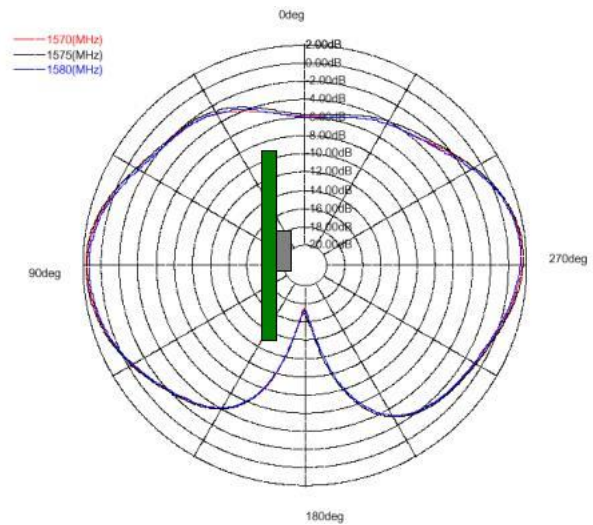

XY-PLANE

